

# FEIDER



**ROBOTIC WINDOW CLEANER**

**FRWC1-1**

**USER GUIDE**

**CAUTION : Read the instructions before using the machine !**

# CONTENTS

1. SAFETY INSTRUCTIONS.....	3
2. PRODUCT DESCRIPTION & PARAMETERS.....	7
3. USE STEPS.....	9
4. CLEANING FUNCTION.....	11
5. POWER FAILURE PROTECTION(BACKUP BATTERY).....	12
6. THE REMOTE CONTROL.....	13
7. TUYA APP OPERATION GUIDE.....	14
8. TROUBLESHOOTING.....	16
9. PRODUCT CARE.....	17
10. DECLARATION OF CONFORMITY.....	18
11. WARRANTY.....	19
12. PRODUCT FAILURE.....	20
13. WARRANTY EXCLUSIONS.....	21

# 1. SAFETY INSTRUCTIONS

## **Attention! Must read before use**

- This appliance shall not be used by children. Keep the appliance and its cord out of reach of children.
- This appliance can be used by persons with reduced physical, sensory or mental capabilities or lack of experience and knowledge if they have been given supervision or instruction concerning use of the appliance in a safe way and understand the hazards involved.
- Children shall not play with the appliance. Cleaning and user maintenance shall not be made by children.
- This product can only be used to clean framed windows and glass (this product is not suitable for cleaning windows and glass without frames). If the window or glass frame has a damaged silicone rubber edge, please be sure to pay special attention to prevent the machine will leak and fall off during the cleaning process. User must observe the using scenario to ensure that the product is used safely and securely.

## **Safety matters**

- **WARNING:** For the purposes of recharging the battery, only use the detachable supply unit JFY72W-240300A2 provided with this appliance. (Using a non-original adapter may cause product failure or damage the product.)
- Make sure the adapter has enough space for ventilation and heat dissipation during use. Do not wrap the power adapter with other objects.

- Do not use the adapter in a humid environment. Please do not touch the power adapter with wet hands during use.
- Please charge the window cleaner at the voltage that the power adapter can withstand.
- Do not use a damaged power adapter, charging cable or power plug. Before cleaning and maintaining the machine, the power plug must be unplugged and do not disconnect the power by unscrewing the extension cord to prevent electric shock. Only charge the battery in this product, do not recharge other non-rechargeable batteries.
- Do not disassemble the power adapter; if the power adapter is faulty, replace the entire power adapter. For assistance and repair, contact your local customer service or distributor.
- This product battery if not handled properly, there is a risk of combustion or chemical discretion injury to the body. Please do not disassemble the battery, so as not to cause a short circuit. Please do not use in fire and high temperature environment above 60°C.
- Please hand over the used battery to the local professional waste battery product recycling center for recycling, the disposal and recycling of used batteries must comply with national laws and regulations.
- Do not immerse this product in liquids (such as beer, water, drinks, etc.) or leave it in a humid environment for a long time.
- Do not expose this product to sunlight and keep this product away from heat sources (such as radiators, heaters, microwave ovens, gas stoves, etc.).
- Do not place this product in a strong magnetic scene.

- Please store this product out of reach of children.
- Please use this product in 0°C~40°C (32°F~104°F) ambient temperature.
- Do not clean damaged glass and objects with uneven surface, this product will not produce enough vacuum suction adsorption on uneven surface or damaged glass machine.
- This appliance contains batteries that are only replaceable by skilled persons.
- Please operate this product in strict accordance with the instructions, if any property damage and personal injury caused by improper use, the manufacturer is not responsible for any.
- The appliance is only to be used with the power supply unit provided with the appliance.
- The appliance must only be supplied at safety extra low voltage corresponding to the marking on the appliance.

### **Attention!**

- Before use, please make sure that the safety rope is not broken and one end is firmly connected to the machine. The other end should be securely attached to other objects in the room to prevent the window cleaner from falling and injuring people or objects.
- If the window glass glue is falling off in the middle section or chipped at the corners due to aging, please use caution and make sure that there is a user supervising the machine during the working period to prevent the machine from falling down and hurting people or objects.

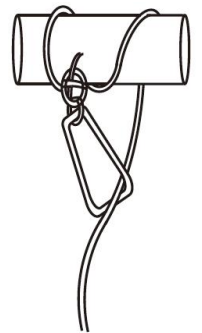

## **Risk of electric shock**

- Make sure the power is completely disconnected and the machine is off before cleaning the body or maintaining the body.
- Do not drag the power plug through the extension cord, power off should be properly unplugged.
- Do not continue to use the product if the machine is damaged/the power supply is damaged.
- Machine is damaged, please contact your local after-sales center or dealer for repair.
- Do not use water to clean the machine body and power adapter.
- Do not use this product in dangerous areas such as open fire, bathroom with water flowing from the open nozzle, by the swimming pool, etc.
- Do not damage or twist the power cord. Do not put heavy objects on the power cord or adapter to avoid damage.

## **Warnings**

- Before operation, make sure to attach the safety rope and tie it securely to a stable indoor unit.
- Before turning on the machine, check the safety rope for damage and secure knotting. Make sure there is no damage and that the knot is secure before using the product.
- When cleaning the glass of a window or door without a blocking table, please set up a safety warning area downstairs.
- Fully charge the built-in backup battery before use (green light on).
- Do not use in rainy or wet weather.
- Turn on the machine first and then place it on the

window glass.

- Make sure the machine is safely attached to the window surface before releasing your hands.
- Before turning off the machine, please hold the machine to avoid dropping it.
- Do not use this product to clean frameless windows or glass .
- Make sure the cleaning cloth is properly attached to the bottom of the machine to prevent air leakage when the window cleaner is adsorbed.
- Do not spray the machine or the bottom of the machine. spray water only on the cleaning cloth.
- Do not allow children to use the machine.
- Please remove any items on glass surface before use.
- Please let hair, loose clothes, fingers or other parts of body keep distance with the working parts of machine.
- Do not use the machine in area of flammable and explosive solids or gases.



Before charging, read the instructions.



For indoor use.

## 2. PRODUCT DESCRIPTION & PARAMETERS

### Product Description

1. Window Cleaning Robot It has a vacuum motor, which can make the machine adsorb on the glass surface and walk freely on the vertical glass surface. Power failure protection (backup battery) can supply power to the equipment to prevent the equipment from falling due to power failure.
2. Window Cleaning Robot has two well-designed cleaning wheels with suction cup, has walking and cleaning functions. The cleaning wheel can absorb and walk on the vertical glass surface. The cleaning cloth on the cleaning wheel can be easily removed and replaced. The cleaning cloth is made of microfiber cloth. the cleaning result is very good.
3. The Window Cleaning robot has artificial intelligence, can plan the path, detect the frame, and automatically clean the entire window. Manual remote control mode, you can freely control the robot.
4. The Window Cleaning robot is upgraded with more advanced artificial intelligence technology,

with a more fashionable appearance and a lighter and thinner body. It has better cleaning performance in more different home environments.

**Specifications**

Adaptor input	100 - 240V~, 50/60Hz, 1.5A Max.
Adaptor output	24 V d.c. 3.0A, 72W
Battery	14.8V d.c. 650mAh
Rating	24 V d.c. 3.75A
External dimensions	295*145*78mm
Suction power	2.8KPa
Net weight	1.1 kg
Power failure protection time	40 minutes
Way to control	Télécommande
Noise	65-70dB(A)
Border detection	automatic
Fall arrest control	Power failure protection (backup battery) safety rope
Cleaning mode	Intelligent path planning modes
Water tank capacity	50ml
Water spraying method	Manual / Auto
Frequency range	2402-2480MHz
Max. Output power	-2.21 dBm Max.
Modulation	GFSK
Max. Antenna gain	2.5dBi
Type of Antenna	PCB Antenna
Frequency range	2432MHz.2452MHz.2471MHz
Max. Output power	1.21dBm Max.
Modulation	GFSK
Max. Antenna gain	2.54dBi
Type of Antenna	PCB Antenna

**Product component name**

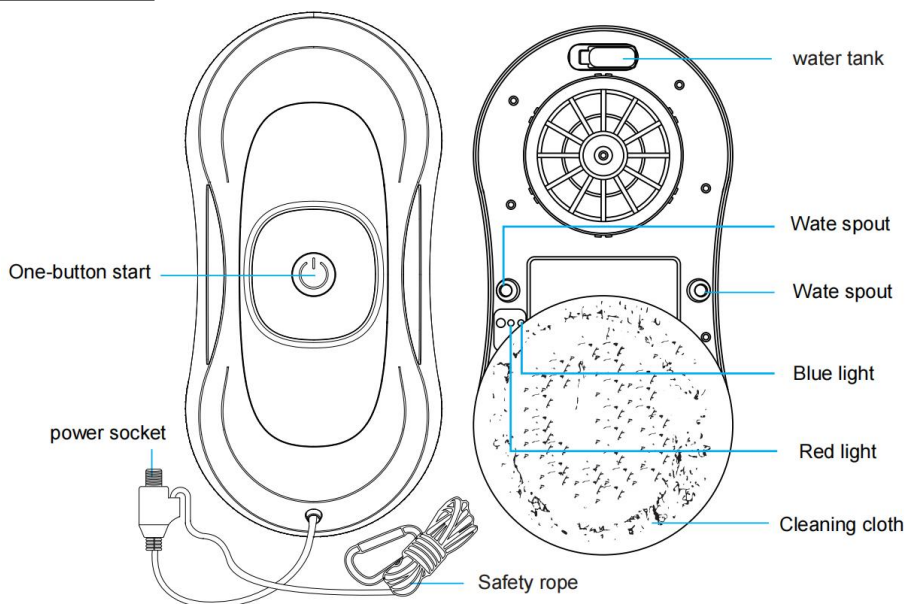

**Power light**

- Blue light : machine is normal
- Orange light : charging

- Red light : machine abnormality
- Green light : charging complete



## Product accessories

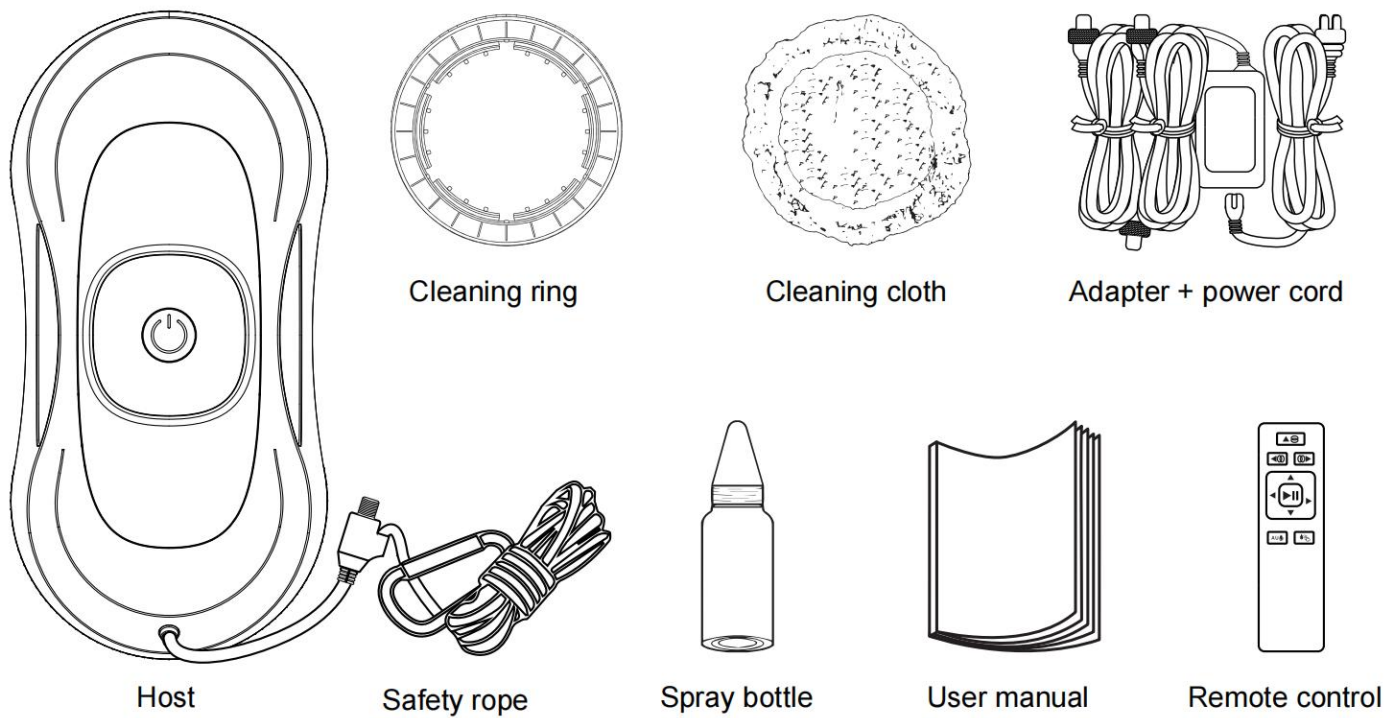

## 3. USE STEPS

### Power connect

- Connect the AC power cord to the adapter.
- Insert the type threaded connector into the power connector of the fuselage and tighten it.
- Plug the power cord into the socket.

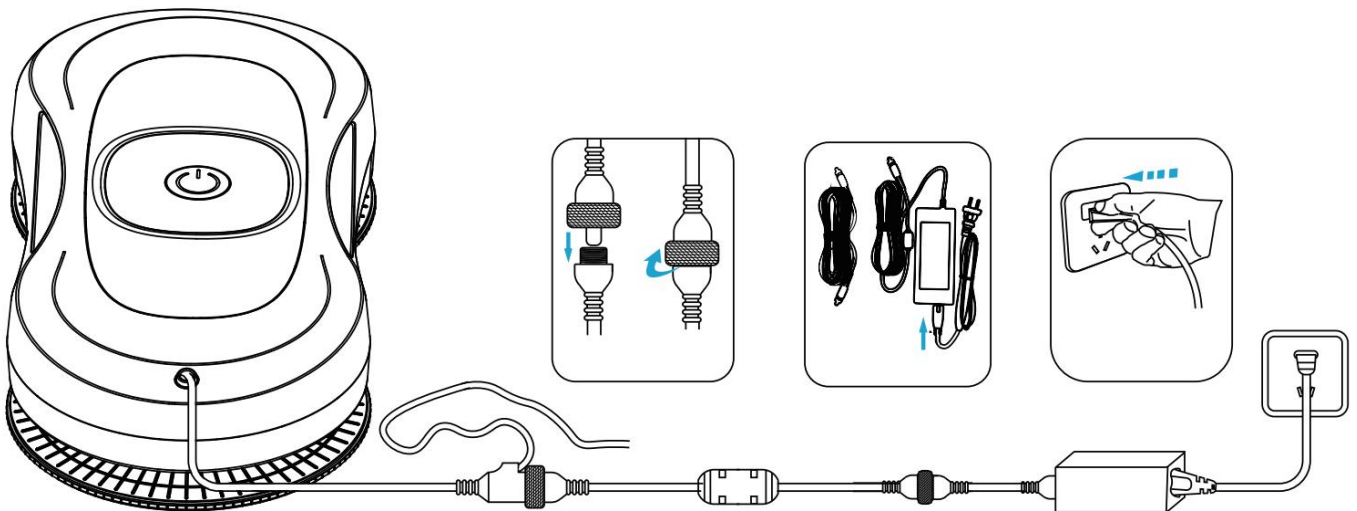

Our device has built-in battery for standby power supply in case of power failure. Please make sure the battery is fully charged before use (green light is on).

A. First turn off the power switch on the device, connect the power cord, and the orange light is on, indicating that it is in the charging state.

B. When the green light is on, means the battery is fully charged.

### Install the cleaning cloth and cleaning ring

According to the diagram, Please make sure the cleaning cloth is put on the cleaning ring, and the cleaning ring is correctly put on the cleaning wheel to prevent air leakage.

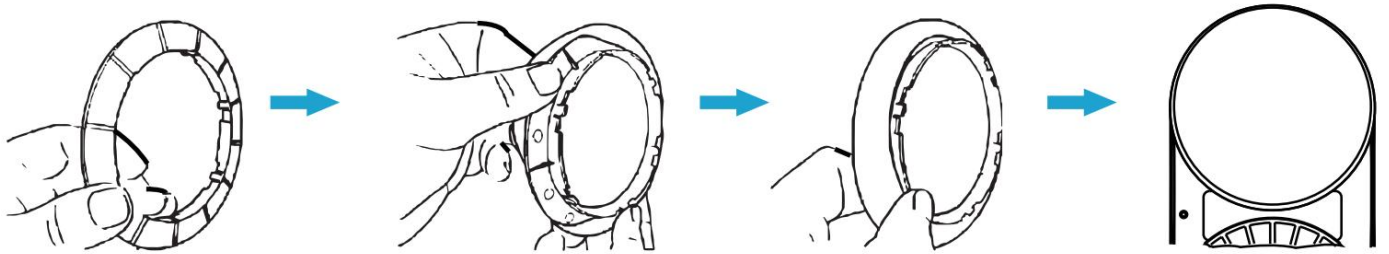

**Attach a safety rope**

- A. For the glass doors and windows without balcony, a danger warning must be put on the ground downstairs, to make sure people do not approach.
- B. Be sure to fasten the safety rope before using, and tie the safety rope to the fixed objects in the house to avoid danger.
- C. Please check whether the safety rope is damaged and whether the knot is loose before using.

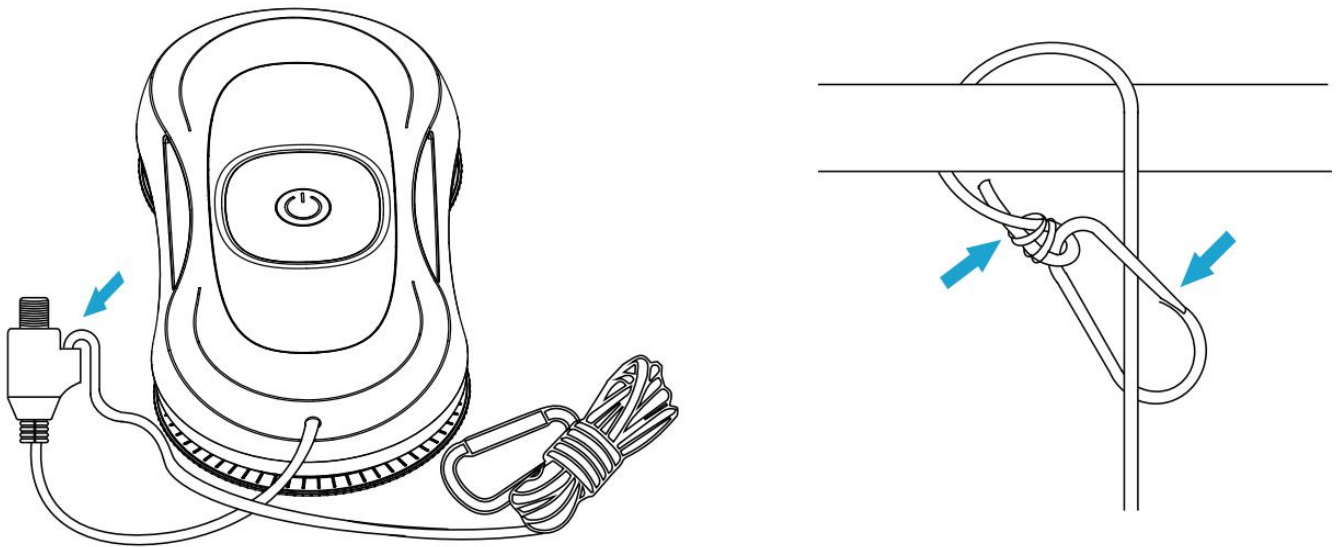

**Water tank add water**

- A. Please do not add any other cleaning agents to the water tank.
- B. Turn the machine over, remove the cleaning ring, open the silicone cover, and add clean and impurities free water. (Figure1, Figure2, Figure3)
- C. Do not fill the water tank with water (80% is sufficient) to maintain stable air pressure.

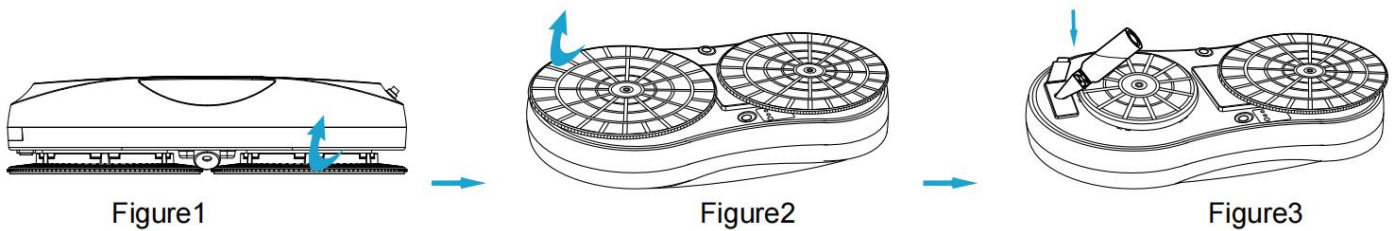

**Attach the machine to the glass**

- A. Press and hold the  button for 2 seconds to turn on, and confirm that the fan rotates.
- B. Put the robot on the glass and keep a certain distance from the window frame.
- C. Make sure that the robot can be attached to the glass, and then let go.



### **Cleaning completed**

- A. Hold the window cleaner with one hand and press the button for 2 seconds with the other hand to turn off the power.
- B. Remove the window cleaning robot from the window.
- C. Untie the safety rope and place the machine and its related accessories in a dry and ventilated environment for next use.

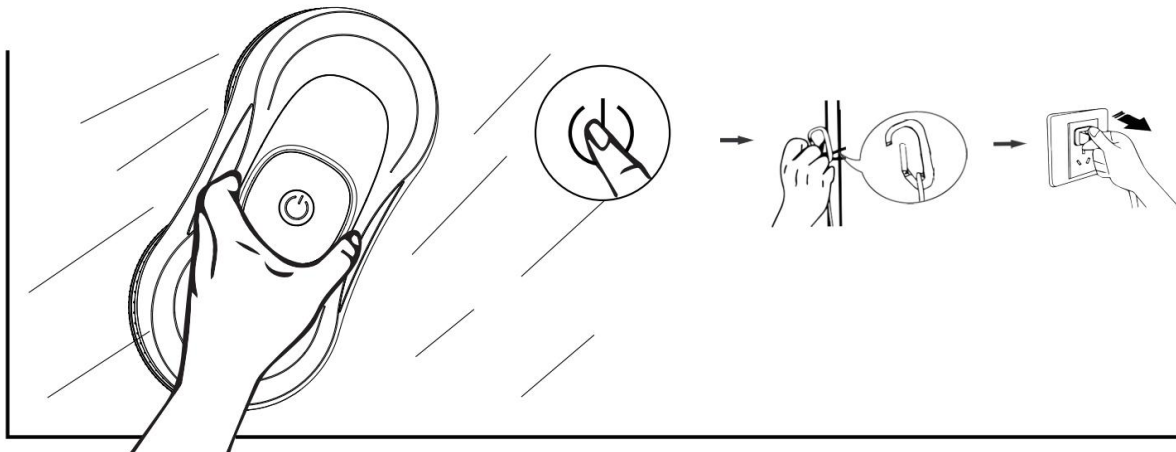

## **4. CLEANING FUNCTION**

### **Dry wipe**

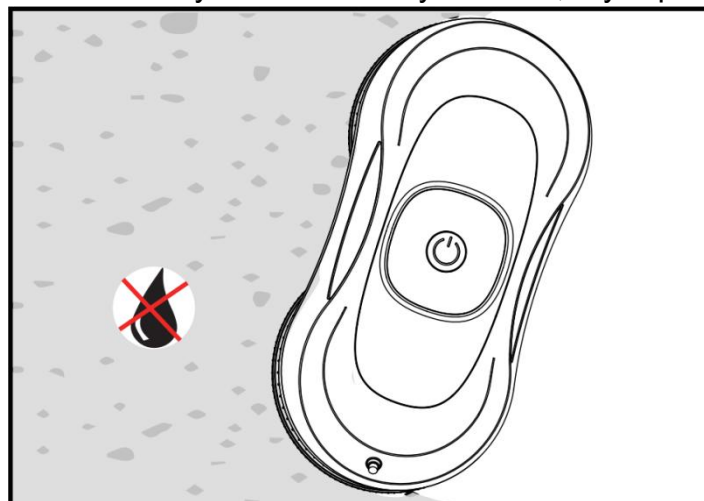

- A. The first time you wipe, be sure to "dry wipe" without spraying water, first remove the sand on the surface of the glass.
- B. If you spray some water (detergent) on the cleaning cloth or glass first, the water (detergent) will mix with the sand and turn into yellow mud, and the wiping effect will be poor.
- C. When the machine is used in sunny or low-humidity weather, dry wipe is the best



## Spray water function

Window cleaning robot set one water spray holes on each side of the left and right sides, when the robot to the left cleaning, the left side spray water, when the robot to the right cleaning, the right side spray water.

### 1. Automatic water spray

- A. When the robot starts cleaning, the automatic water spraying mode is turned on by default, with intermittent automatic water spraying.
- B. Press the  button on the remote control, the robot will make two beeps, and the automatic water spray mode has been turned on.
- C. Press the  button on the remote control, and the robot will make a beep, indicating that the automatic water spray mode is turned off.

### 2. Manual water spray

When the window cleaning robot is in the auto cleaning mode, the machine is in the forward direction, press the "" button on the remote control, press once to spray water once.

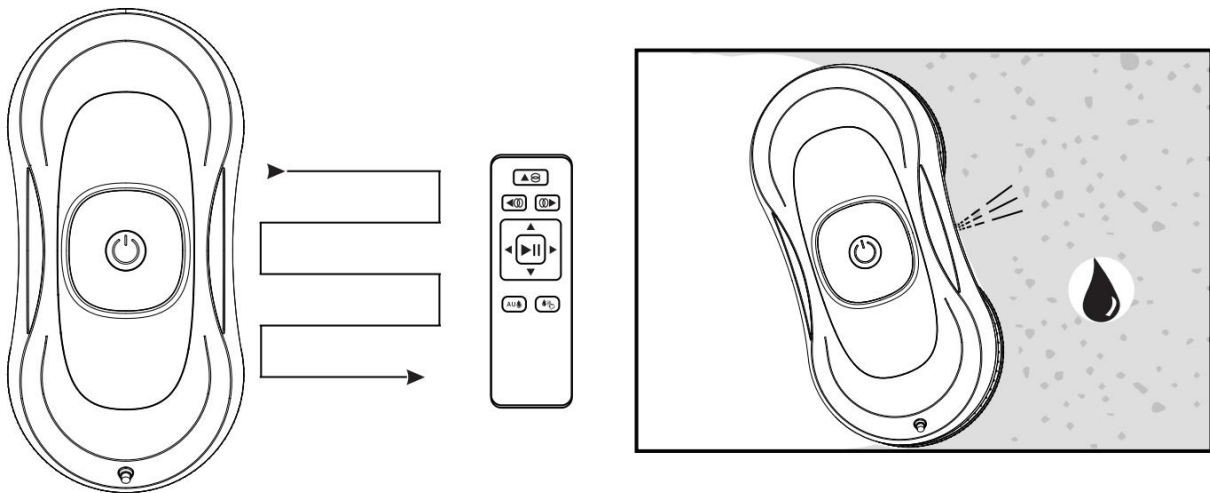

## Intelligent path planning modes

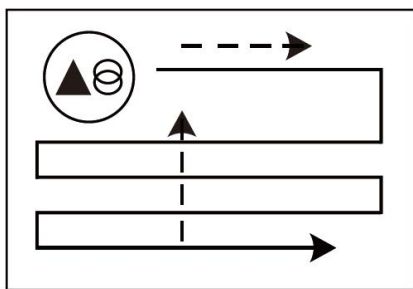

Climb to the top and then automatic clean

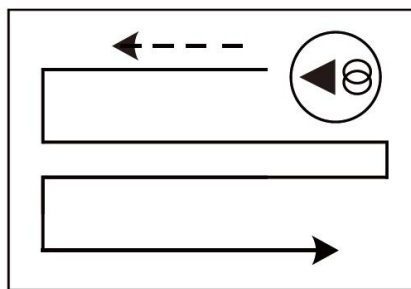

Auto clean from right to left

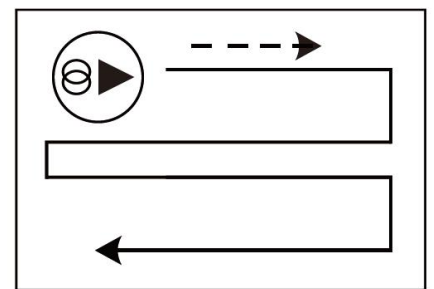

Auto clean from left to right

This product no need to be cleaning and user maintenance, just wash the cleaning cloth after using each time.

## 5. POWER FAILURE PROTECTION (BACKUP BATTERY)

- A. In case of power failure, the device will start the built-in backup battery power, which can last for 40 minutes (when the battery is fully charged).
- B. In the event of a power failure, the machine will stay in place and will not move forward, and will emit a warning sound.. The red/blue lights will flash alternately. Return to the machine as soon as possible to avoid falling from the glass due to the power failure.
- C. Use the safety rope to gently pull the device back; when pulling the safety rope, keep it as close to the glass as possible to avoid falling.



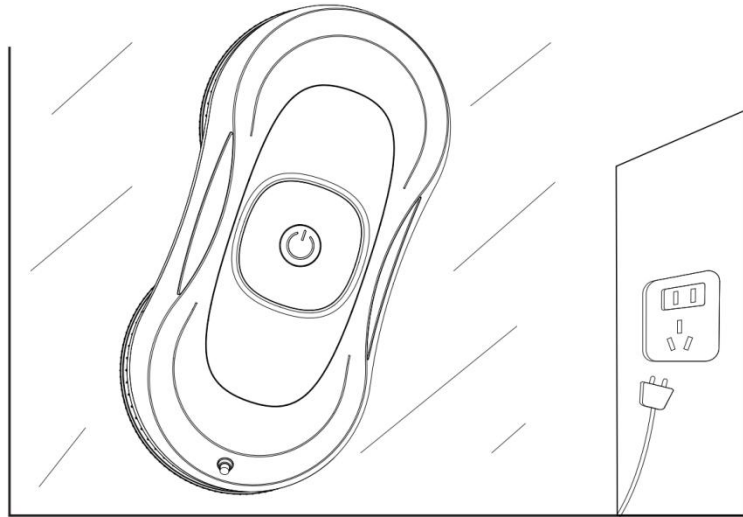









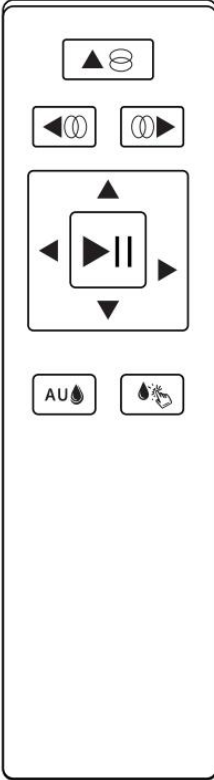

## 6. THE REMOTE CONTROL

A. Do not charge the remote control battery, do not disassemble the battery, do not put the battery in fire, there is a possibility of detonation.

B. Please use No., AAA/RL batteries of the same specification as required, please do not use different types of batteries, there is a danger of burning the circuit, when the battery is installed and removed, push the remote control cover down, open the battery cover, and install .When using the battery, align the negative pole with one end of the spring first, press it down, the reverse installation of the battery is invalid, and then cover the battery cover.

- C.
- different types of batteries or new and used batteries are not to be mixed;
  - batteries are to be inserted with the correct polarity;
  - exhausted batteries are to be removed from the appliance and safely disposed of;
  - if the appliance is to be stored unused for a long period, the batteries should be removed;
  - the supply terminals are not to be short-circuited.

 Climb to the top and then automatic clean	 Manual upward movement	
 Auto clean from right to left	 Manual downward movement	
 Auto clean from left to right	 Manually move to the left	
 Automatic water spray	 Manually move to the right	
 Manual water spray	 Start / Pause	

# 7. TUYA APP OPERATION GUIDE



TUYA smart

1. Open the App store your phone.
2. Search for "Tuya" App.
3. Click to download and install.

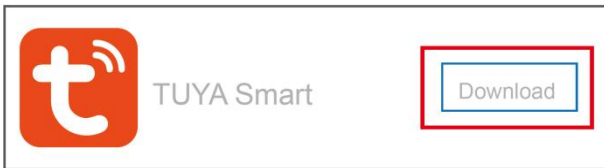

4. Click to open the "Tuya" App.
5. Click on "Agree".

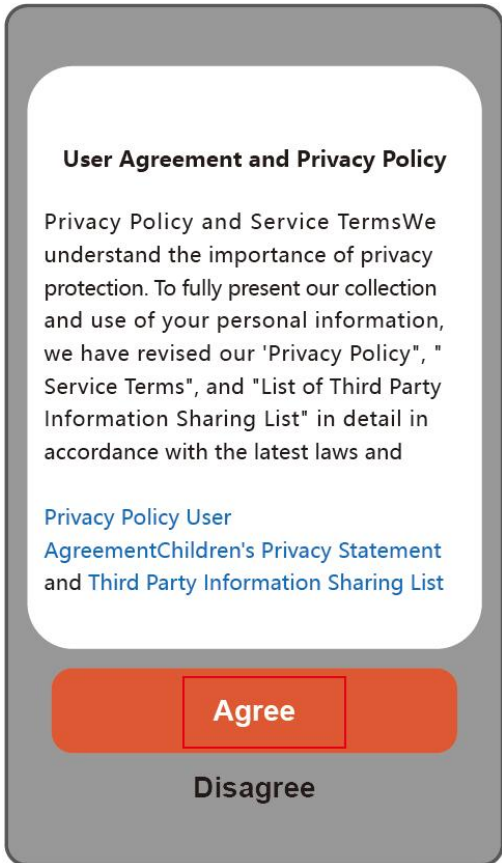

6. Type "✓" and then click "Click LogIn"

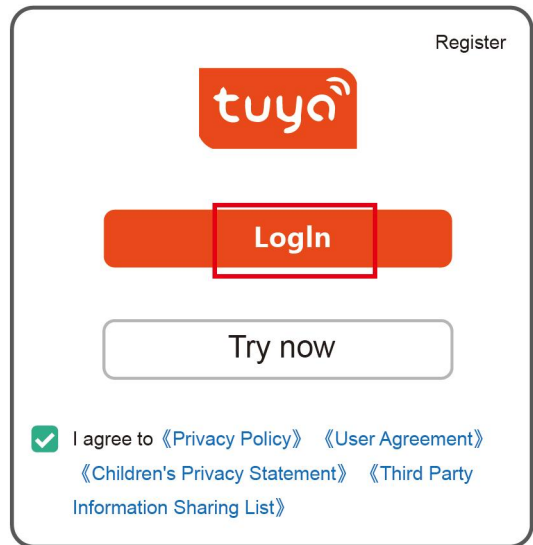

7. Turn on Bluetooth:

The robot connects power and open the bluetooth on smart phone.

8. Click on "Add Device":

Make sure your device has entered pairing mode

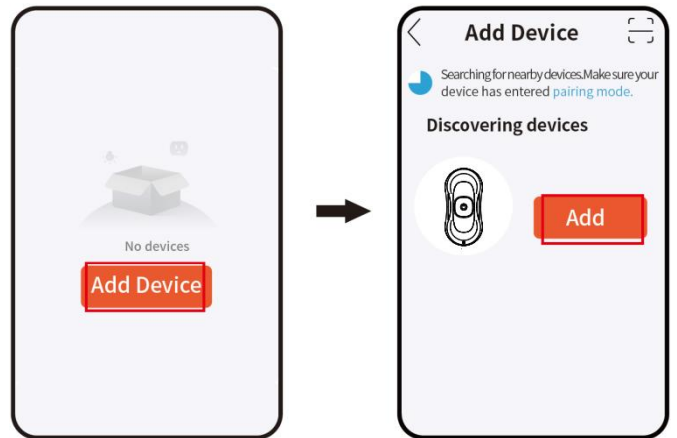

9. Click on "Done"

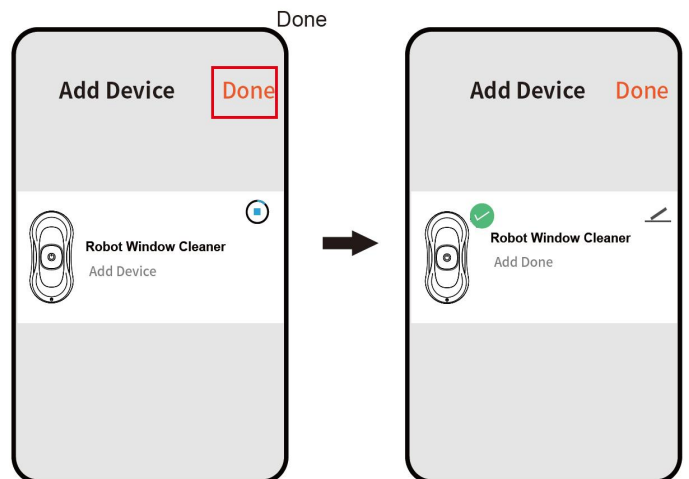

10. (1) Click "window cleaning robot" (2) Click "⏻" to start the robot

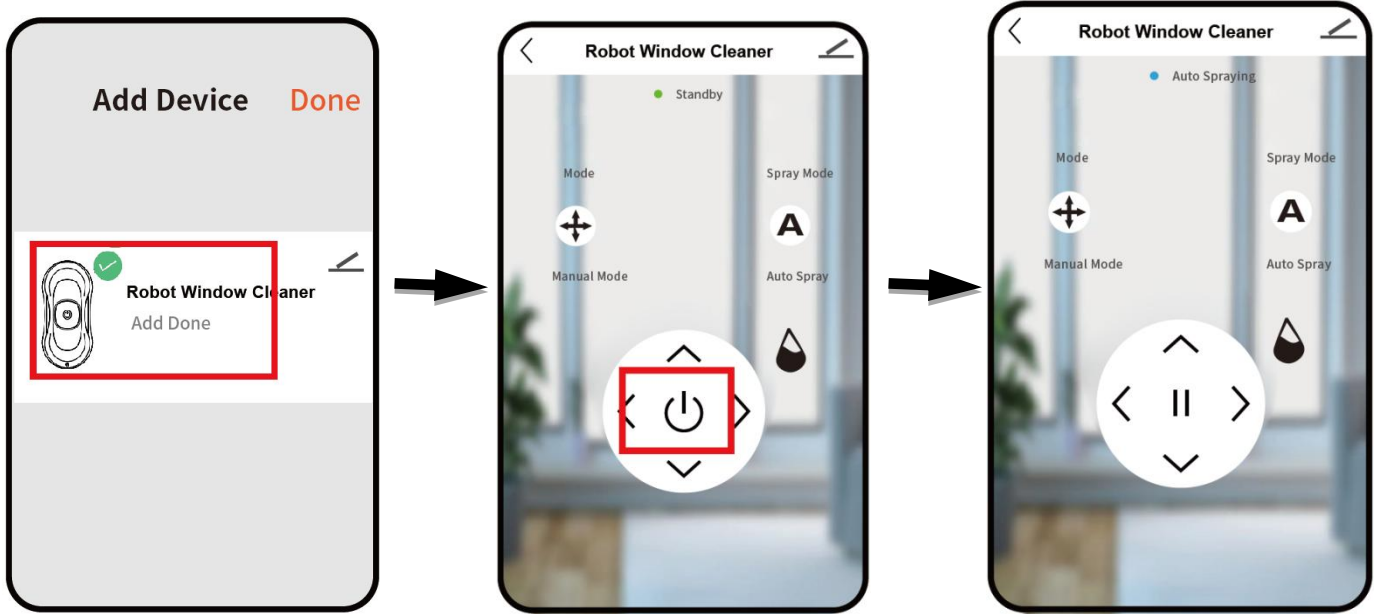

11. Click on Control panel to enter clean mode ⬆

Clean mode:

- ⬆ Manual Mode
- ⬆ Up Mode
- ⬆ Left Mode
- ⬆ Right Mode

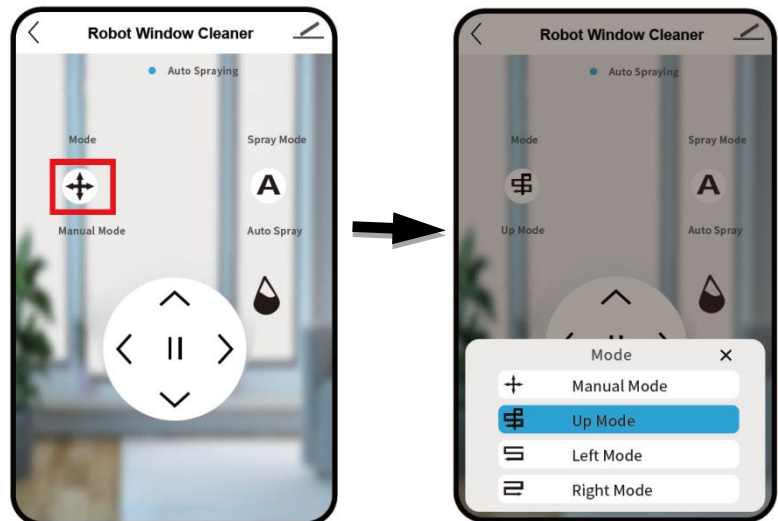

12. Click on the control panel to enter the water spray mode **A**

Water spray mode:

- A** Automatic Water Spray Mode
- M** Manual Spray Mode

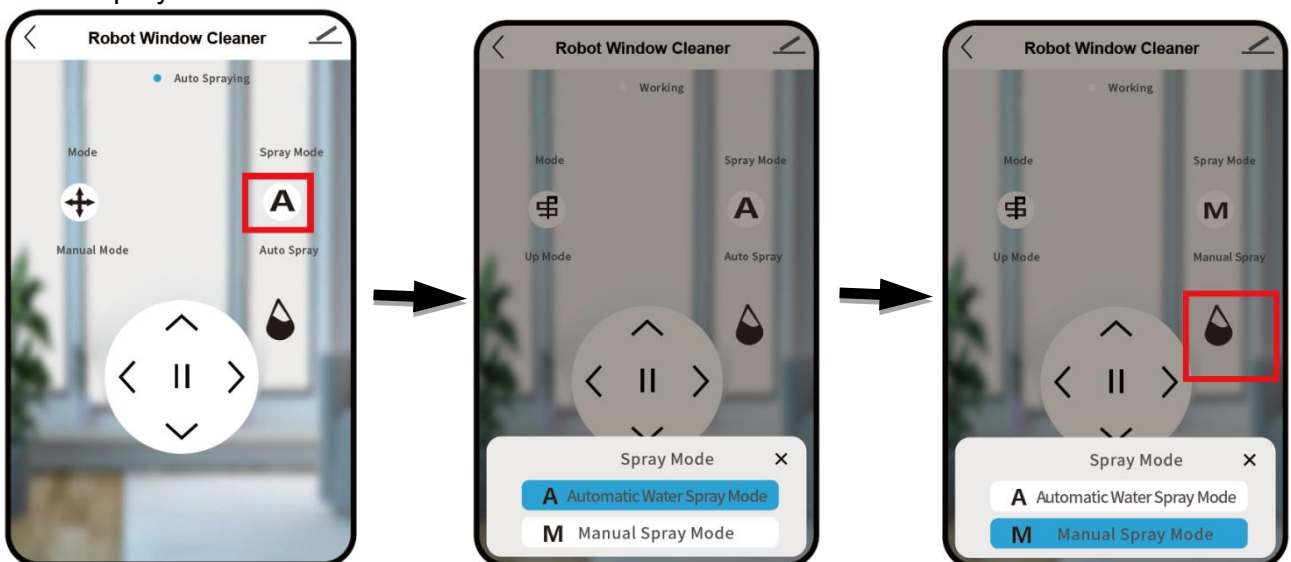

## 8. TROUBLESHOOTING

1. When the cleaning cloth is used for the first time (especially in the dirty environment of the outer window glass), the machine may run slowly or even fail:

- A. When unpacking the machine, clean and dry the supplied cleaning cloth before use.
- B. Spray a little water or glass water evenly on the cleaning cloth or the surface of the glass to be wiped.
- C. After the cleaning cloth is dampened and wrung out, put it into the cleaning ring of the machine for use.

2. The machine will test itself at the beginning of operation. If it can not run smoothly and there is a warning sound, it means that the friction is too large or too small:

- A. Whether the cleaning cloth is too dirty.
- B. The efficient of friction of glass stickers and fog stickers is relatively low, so they are not suitable for use.
- C. When the glass is very clean, it will be too slippery.
- D. When the humidity is too low (air conditioning room), the glass will be too slippery after wiping for many times.



3. When pressing the up automatic cleaning button  , the machine can't detect the upper edge of the window due to the sliding of the upper edge of the window:

Please press the  key to switch to  or  auto clean mode.



4. The machine cannot wipe the upper left side of the glass:

You can use the remote control manual window cleaning mode to wipe the part that has not been wiped (sometimes the glass or cleaning cloth is slippery, the width of the wiped glass is larger, and the top line slides a little, resulting in the upper left position can not be wiped).

5. The machine can't clean the windows completely, but finish the cleaning work ahead of time:

You can press  or  auto window mode to continue the unfinished part.

6. Possible reasons for slipping and not climbing when climbing:

- A. The friction is too small. The friction coefficient of stickers, thermal insulation stickers or fog stickers is relatively low.
- B. The cleaning cloth is too wet When the glass is very clean, it will be too slippery.
- C. When the humidity is too low (air conditioning room), the glass will be too slippery after wiping for many times.
- D. When starting the machine (press  or  or  ), please place the machine at a distance from the window frame to avoid wrong judgment.

7. After cleaning, round wheel marks remain on the glass surface:

The cleaning cloth is too dirty. Please replace it with a clean cloth and wipe it again.

8. The machine doesn't run smoothly. Possible reasons:

- A. The cleaning cloth is too dirty. Please replace it.
- B. There are different areas on the glass surface (glass area, sticker area, thermal insulation sticker area or fog sticker area). Please use it in a single area.
- C. If the screw of the cleaning wheel is loose, please lock it (do not lock it too tightly, otherwise it may affect the glass glue thickness at the bottom of the window frame or the performance of the



beveled window frame).

9. How to deal with the warning sound and red light flashing when the machine stops operation due to power failure:

A. Gently pull the safety rope back to the machine; when pulling the safety rope, it should be close to the parallel glass as far as possible to avoid falling.

B. Turn off the machine power switch.

C. Check the wire for poor contact or broken wire.

10. The machine stops when encountering unknown obstacles, the red light flashes and there is no warning sound. How to deal with it:

A. Let the machine back to safe position via remote control. Or gently pull the safety rope back to the machine, when pulling the safety rope, it should be close to the parallel glass as far as possible to avoid falling.

B. Remove the obstacles on the window.

C. Check if there is the reason caused air leak.

11. There are arc marks on the polished glass when the light is shining at night:

For the first time, please turn off the water spraying function and use a clean cloth to remove the sand. For the second wipe, clean and replace the clean cloth, turn on the water spraying function, or keep the upper cleaning wheel clean and dry, and spray a little detergent or alcohol on the lower cleaning wheel (1 or 2 spray), which can not be completely wet, and can eliminate the arc trace. All wet cleaning cloth will affect the operation of the.

12. The machine has cleaned all the windows, but it can't stop automatically:

Please press the  button to stop the operation.

13. The machine will not spray water:

A. Please confirm whether the water spray function switch is on.

B. Clean the ultrasonic nozzle with a clean soft cloth.

C. Please check the water tank whether there is water and whether the added cleaning solution is clean and pure.

## 9. DISPOSAL



When the product has reached the end of its life, it and the Li-Ion battery should not be disposed of with general household waste. The battery should be removed from the product and both should be disposed of properly at a recognized recycling facility.

### FOR HOUSEHOLD USE ONLY



Electrical products should not be discarded with household products. According to the European Directive 2012/19/EU on waste electrical and electronic equipment and its implementation into national law, electrical products used must be collected separately and disposed of at collection points provided for this purpose. Talk with your local authorities or dealer for advice on recycling.

# 10. DECLARATION OF CONFORMITY



BUILDER SAS

32 rue Aristide Bergès - Z.I. du Casque - 31270 Cugnaux - France

Declares that the machine indicated below:

Designation: ROBOTIC WINDOW CLEANER

Model: FRWC1-1

Serial number: 20241100001-20241101200

Is in conformity with the European Directives:

Radio Equipment Directive 2014/53/EU

EMC Directive 2014/30/EU

LVD Directive 2014/35/EU

ROHS Directive: (EU) 2015/863 amending 2011/65/EU

This product is also in conformity with the following standards:

Window cleaner:

EN 60335-1:2012+A11:2014+A13:2017+A1:2019+ A14:2019+A2:2019+A15:2021+A16:2023  
EN 62233 :2008

Charger:

EN 60335-1:2012/A15:2021,  
EN IEC 60335-2-29:2021/A1:2021

EN 50663: 2017; EN 62479: 2010

ETSI EN 301 489-1 V2.2.3 (2019-11)

ETSI EN 301 489-17 V3.2.4 (2020-09)

EN IEC55014-1:2021

EN IEC55014-2: 2021

EN IEC 61000-3-2:2019+A1:2021

EN 61000-3-3:2013+A1:2019+A2:2021

ETSI EN 300 328 V2.2.2 (2019-07)

Philippe MARIE / PDG

Cugnaux, le 18/08/2024

Responsible of technical file: M. Olivier Patriarca

# 11. WARRANTY

The manufacturer guarantees the product against defects in material and workmanship for a period of 5 years from the date of the original purchase. It can be extended by one year if the user subscribes to website of myswap. The warranty only applies if the product is for household use. The warranty does not cover breakdowns due to normal wear and tear.

The manufacturer agrees to replace parts identified as defective by the designated distributor. The manufacturer does not accept responsibility for the replacement of the machine, in whole or in part, and/or ensuing damage.

## **The warranty does not cover breakdowns due to:**

- insufficient maintenance.
- abnormal assembly, adjustment or operations of the product.
- parts subject to normal wear and tear.

## **The warranty does not extend to:**

- shipping and packaging costs.
- using the tool for a purpose other than that for which it was designed.
- the use and maintenance of the machine done in a manner not described in the user manual.

Due to our policy of continuous product improvement, we reserve the right to alter or change specifications without notice. Consequently, the product may be different from the information contained therein, but a modification will be undertaken without notice if it is recognized as an improvement of the preceding characteristic.

## **READ THE MANUAL CAREFULLY BEFORE USING THE MACHINE.**

When ordering spare parts, please indicate the part number or code, you can find this in the spare parts list in this manual. Keep the purchase receipt; without it, the warranty is invalid. To help you with your product, we invite you to contact us by phone or via our website:

**+33 (0)9.70.75.30.30**

**<https://services.swap-europe.com/contact>**

You must create a "ticket" via the web platform.

- Register or create your account.
- Indicate the reference of the tool.
- Choose the subject of your request.
- Describe your problem.

Attach these files: invoice or sales receipt, photo of the identification plate (serial number), photo of the part you need (for example: pins on the transformer plug which are broken).



**swap**

## 12. PRODUCT FAILURE

### WHAT TO DO IF MY MACHINE BREAKS DOWN?

#### If you bought your product in a store:

- Make sure that your machine is complete with all accessories supplied, and clean! If this is not the case, the repairer will refuse the machine.
- Go to the store with the complete machine and with the receipt or invoice.

#### If you bought your product on a website:

- Make sure that your machine is complete with all accessories supplied, and clean! If this is not the case, the repairer will refuse the machine.
- Create a SWAP-Europe service ticket on the site: <https://services.swap-europe.com> When making the request on SWAP-Europe, you must attach the invoice and the photo of the nameplate (serial number).

Contact the repair station to make sure it is available before dropping off the machine.

Go to the repair station with the complete machine packed, accompanied by the purchase invoice and the station support sheet downloadable after the service request is completed on the SWAP-Europe site

**Please keep your original packaging to allow for after-sales service returns or pack your machine with a similar cardboard box of the same dimensions.**

For any question concerning our after-sales service you can make a request on our website <https://services.swap-europe.com>

Our hotline remains available at +33 (9) 70 75 30 30.



## 13. WARRANTY EXCLUSIONS

### THE WARRANTY DOES NOT COVER:

- Start-up and setting up of the product.
- Damage resulting from normal wear and tear of the product.
- Damage resulting from improper use of the product.
- Damage resulting from assembly or start-up not in accordance with the user manual.
- Periodic and standard maintenance events.
- Actions of modification and dismantling that directly void the warranty.
- Products whose original authentication marking (brand, serial number) has been degraded, altered or withdrawn.
- Replacement of consumables.
- The use of non-original parts.
- Breakage of parts following impacts or projections.
- Accessories breakdowns.
- Defects and their consequences linked to any external cause.
- Loss of components and loss due to insufficient screwing.
- Cutting components and any damage related to the loosening of parts.
- Overload or overheating.
- Poor power supply quality: faulty voltage, voltage error, etc.
- Damages resulting from the deprivation of enjoyment of the product during the time necessary for repairs and more generally the costs related to the immobilization of the product.
- The costs of a second opinion established by a third party following an estimate by a SWAP-Europe repair station
- The use of a product which would show a defect or a breakage which was not the subject of an immediate report and/or repair with the services of SWAP-Europe.
- Deterioration linked to transport and storage\*.

\* In accordance with transport legislation, damage related to transport must be declared to carriers within 48 hours maximum after observation by registered letter with acknowledgement of receipt. This document is a supplement to your notice, a non-exhaustive list.

**Attention:** all orders must be checked in the presence of the delivery person. In case of refusal by the delivery person, it you must simply refuse the delivery and notify your refusal.

**Reminder:** the reserves do not exclude the notification by registered letter with acknowledgement within 72 hours.

#### **Information:**

Thermal devices must be wintered each season (service available on the SWAP-Europe site). Batteries must be charged before being stored.

# FEIDER



CE

BUILDER SAS

32 rue Aristide Bergès - Z.I. du Casque - 31270 Cugnaux - France

Made in PRC